

PRACC

PLENTY RANGES ARTS
& CONVENTION CENTRE



Function Technical Specifications

Updated 15/08/2024

Capacity Guidelines

All meeting rooms' maximum capacities include allowances for audio-visuals and staging.

Foyer capacities are influenced by catering, exhibition and safety requirements and are subject to change based on your final event arrangements.

Maximum venue capacities are consistent with safe-work guidelines.

Any requests to work outside of the capacity guidelines will be subject to operational approval and OH&S compliance.

Hire Space	U-Shape	Theatre	Boardroom	Classroom	Cabaret	Banquet	Cocktail
Eucalypt Room		450		300	280	400	700
Red Gum Room	32	200	40	130	130	180	200
Blue Gum Room	32	200	40	130	130	180	200
Lakeview Room	20	30	30	30	30		30

ROOM DETAILS

Room Dimensions- Eucalypt

Floor to Lower Ceiling	3500mm
Floor to Higher Ceiling	4800mm
Entrance Door to Emergency Door (Blue Gum Side)	23700mm
Entrance Door to Window (Middle of Room)	22300mm
Entrance Door to Window (Red Gum Side)	24850mm
Shortest	1316mm
Longest	48950mm

Room dimensions - Red Gum

Length	24850mm
<u>Width:</u>	
Shortest	5100mm
Longest	24500mm

PRACC

PLENTY RANGES ARTS
& CONVENTION CENTRE

Room Dimensions - Blue Gum

Length	2370mm
<u>Width:</u>	
Shortest	7300mm
Longest	23670mm

Room Dimensions - Lakeview

Floor to Lower Ceiling	2360mm
Floor to Higher Ceiling	2630mm
<u>Length:</u>	
Shortest	6950mm
Longest	11500mm
<u>Width:</u>	
Shortest	4350mm
Longest	12850mm

Room Dimensions - Lakeview Left

<u>Length:</u>	
Shortest	6950mm
Longest	9300mm
<u>Width:</u>	
Shortest	4350mm
Longest	7900mm

Room Dimensions - Lakeview Right

<u>Length:</u>	
Shortest	8100mm
Longest	11500mm
<u>Width:</u>	
Shortest	4400mm
Longest	4950mm

POWER

240v Outlet	27 (Located approximately every 3500mm - 5000mm)
3-Phase Outlet	In Storage Room Two Outlets between the entrance doors

WiFi

WiFi	City of Whittlesea Free Public WiFi
------	-------------------------------------

PRACC

PLENTY RANGES ARTS
& CONVENTION CENTRE

STAGING DETAILS

Stage Description

Rectangle pieces of staging. Black carpeted staging. Black removable skirting.

Staging Load Limit 610kg per square metre of staging (uniform distribution)

Stage Dimensions

1 piece of stage 1830mm(W) x 2440mm(L) x 410mm(H)

Stage Placement

Total Pieces of Staging	8
Between Screens - Eucalypt	Maximum 4 Pieces
Between Entrance Doors - Eucalypt	Maximum 2 Pieces
Entrance Door- Blue/Red Gum	Maximum 1 Piece
Beside Screen- Blue/Red Gum	Maximum 4 pieces

Ramp

Length	6000mm
Height	415mm
Angle	4.65°



Equipment Details

Tables

Type	Dimensions	Total
Plastic Trestle	1.8m x 0.75m	55
Wooden Trestle	2.4m x 0.76m	12
Bar Tables	60cm Diameter 11cm Height	8

Audio-Visual Equipment

** Please be aware that technical equipment is shared with the PRACCs Theatres and is subject to availability

Laptop

Make	Model	Total
Dell**	Latitude E5570	1

Data Projector

Make	Model	Detail	Input	Total
Mitsubishi	WD720U	2 Window-Facing 2 Centre-Facing	HDMI	4

TV

Make	Model	Detail	Inputs	Total
TCL	60E6000US	Lakeview Only	Wireless, HDMI	1
TCL	55E4800-FS	Lakeview Only	Wireless, HDMI	1
Panasonic**	Plasma	Portable	HDMI, Composite, VGA	2

Control Positions

Behind screens at window
In between entrance doors

Lectern

Laptop stand attachment
Connection can be made available for HDMI laptop input
Has built in microphone (Shure MX418)
Dimensions 1150mm (H) x 750 (W)

LIGHTING DETAILS

House Lighting

Independent control	Yes
Control Positions	Either side of entrance doors
Dimmable	100%, 75%, 50%

Room Colour Lighting:

1 = White
2 = Dark Blue
3 = Pink
4 = Light Blue
5 = Purple
6 = Red
7 = Green

Lighting bars

Bar Dimensions	4500mm (L) x 49.4mm (D)
Batten W.L.L.	100kg
Number of bars	4

Patching:

Location	Quantity	Numbering	Detail / Accessories
1	6		Dimmer in Storage Room
2	6		Dimmer in Storage Room
3	6		Dimmer in Storage Room
4	6		Dimmer in Storage Room

Additional Lighting

Theatrical Lighting is available if interested; please be aware that this may carry an additional cost for equipment and operations and is subject to availability as equipment is shared with PRACCs Theatres. If interested, please speak to your Event Planner.

PRACC

PLENTY RANGES ARTS
& CONVENTION CENTRE

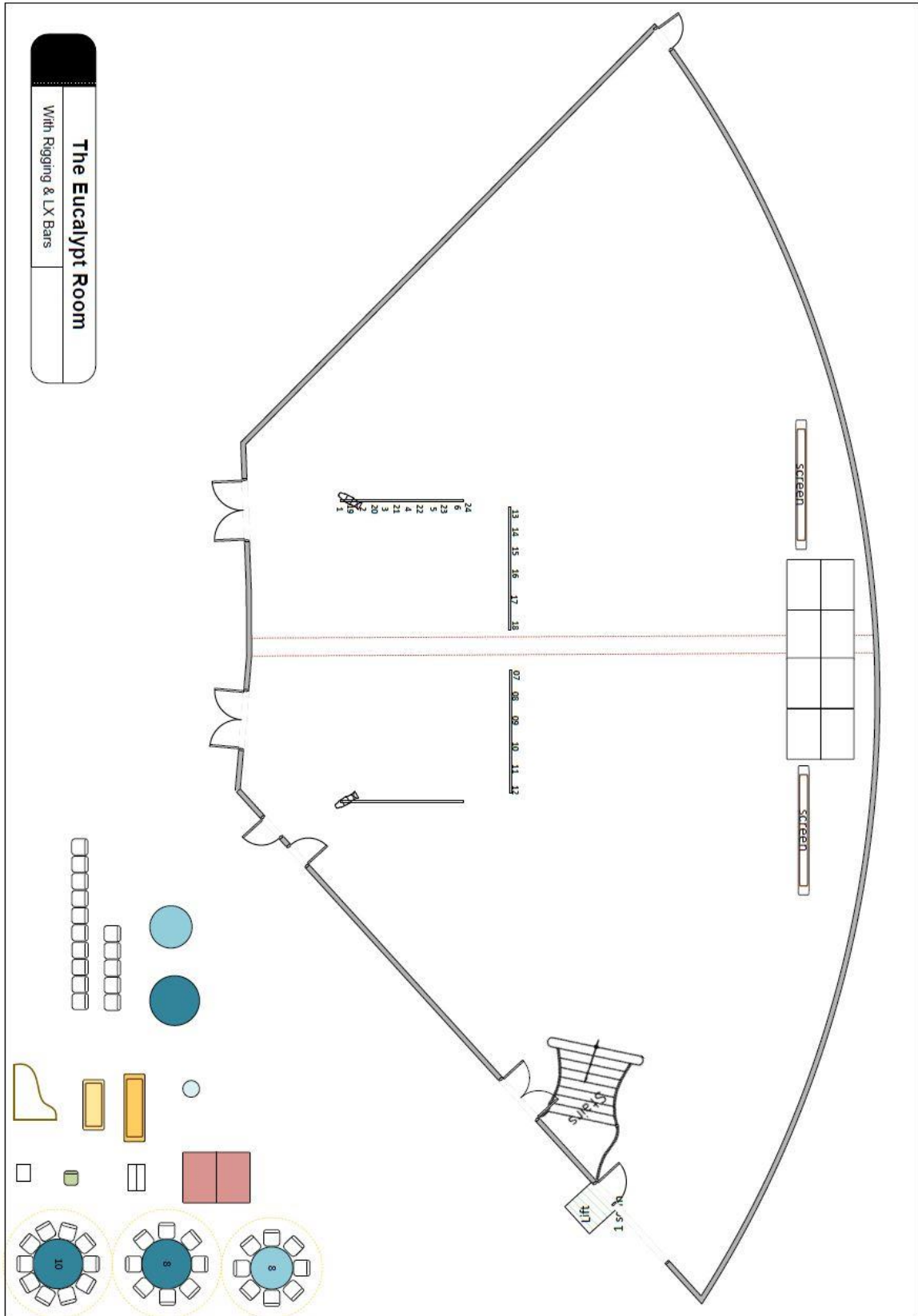

AUDIO

** Please be aware that technical equipment is shared with the PRACCs Theatres and is subject to availability.

Microphones / DI's:

Make	Model	Detail / Accessories	Use	Total
Sennheiser	ew300 G3 e835	Handheld Microphone	Vocals	3
Sennheiser	ew300 G3 Beltpack	Beltpack Transmitter	Vocals	1
Sennheiser	ew300 G3	Wireless Receiver	Vocals / Inst	3
Sennheiser**	ew500 G3 e935	Handheld Microphone	Vocals	4
Sennheiser**	ew500 sk500	Beltpack Transmitter	Vocals / Inst	4
Sennheiser**	ew500 G3	Wireless Receiver	Vocals / Inst	4
Optim	Optim Lapel	Lapel	Vocals	4
Shure**	MX418	Lectern	Lectern	1
Shure**	SM 58	Clips	Vocals	15
Shure**	SM 57	Clips	Instruments	10
Shure**	SM 94	Clips	Instruments	10
Shure **	Beta52	Internal Clip	Kick Drum	2
Sennheiser **	E 602 MKII	Clip	Kick Drum	1
Rode**	NT5	Clips	Instruments	4
Radial **	JDI Passive	Mono DI	Instruments	2
Radial **	Duplex	Stereo DI	Instruments	1
Klark Teknik**	DN100	DI	Inst	8

Accessories:

Item	Model	Detail / Accessories	Total
Microphone Stands**	Tripod Base	With Boom Arm	12
Microphone Stands**	Tripod Base	Small	4
Microphone Stands**	Round Based	Vertical (no Boom Arm)	4
Music Stands**	K&N KM10068	With Clip on Lights	15
Drum Mic Clips**	K&N 24030B	Drum Microphone Clip	4
Speaker Stands**	Tripod Base	Large	2

Speakers:

Item	Model	Detail / Accessories	Total
Ceiling Mounted Speakers		Standard	20
10" PA Speaker**	RCF ART 300a	Powered Speaker	2
15" PA Speaker**	RCF ART 315a	Powered Speaker	2

LOADING DOCK

Access

Access to the loading dock for the Eucalypt room is via the access road. The access road starts to the left of the round-about at the entrance of Plenty Ranges Arts & Convention Centre. The road goes around the building. Large vehicles can turn around in loading bay.

Dimensions

Roller Door 2245mm (H) x 3000mm (W)

PRACC

PLENTY RANGES ARTS
& CONVENTION CENTRE

VENUE DETAILS

Venue Contacts:

Venue Address

35 Ferres Boulevard, South Morang, Vic, 3752

Venue Postal Address

Locked Bag 1, Bundoora MDC, Bundoora, Vic, 3083

Staff Contacts:

Coordinator Cultural Venues

Email Address

Phone Number

Mobile

Matthew Cartledge

Matthew.cartledge@pracc.com.au

(03) 9217 2150

0429 528 030

Technical Operations Coordinator

Email Address

Phone Number

Mobile

Ash Whelan

Ash.whelan@pracc.com.au

(03) 9217 2463

0447 319 806

Venue Operations Coordinator

Email Address

Phone Number

Mobile

Vanessa Lacock - Smith

Vanessa.lacocksmith@pracc.com.au

(03) 9217 2320

0408 503 346

Eucalypt Room

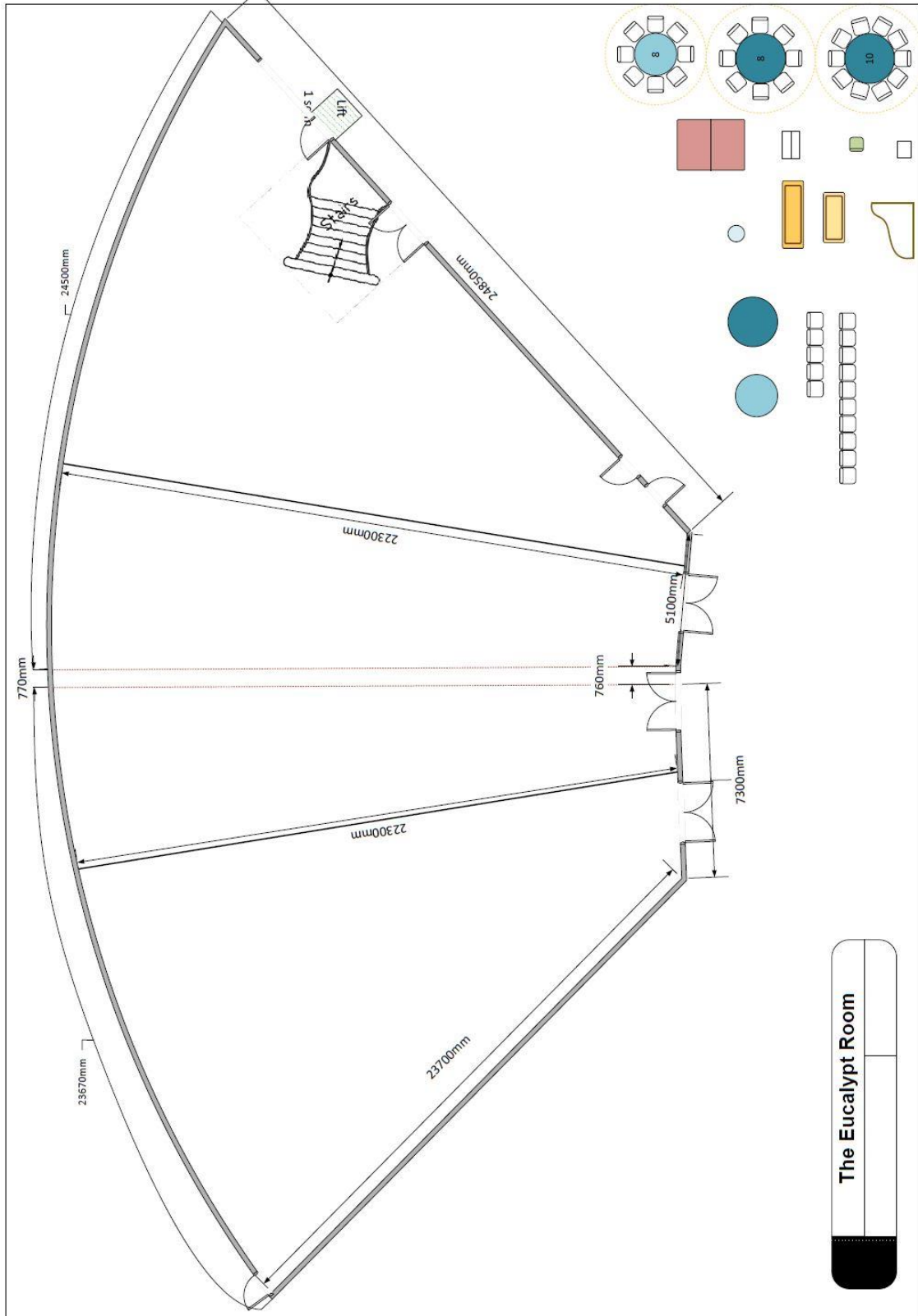

Lakeview Room

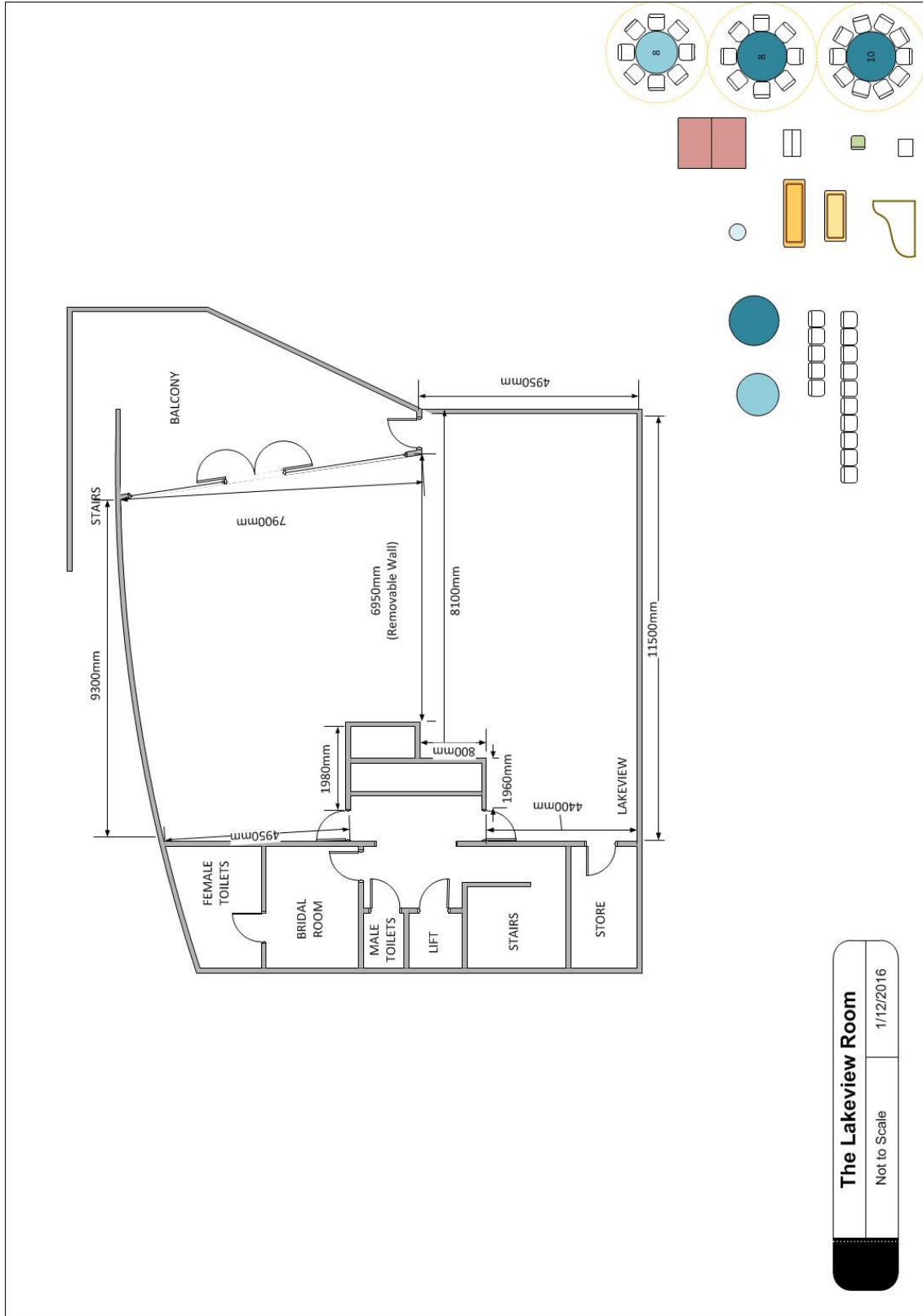

The Lakeview Room
 Not to Scale
 1/12/2016

Eucalypt Room with Rigging & LX Bars

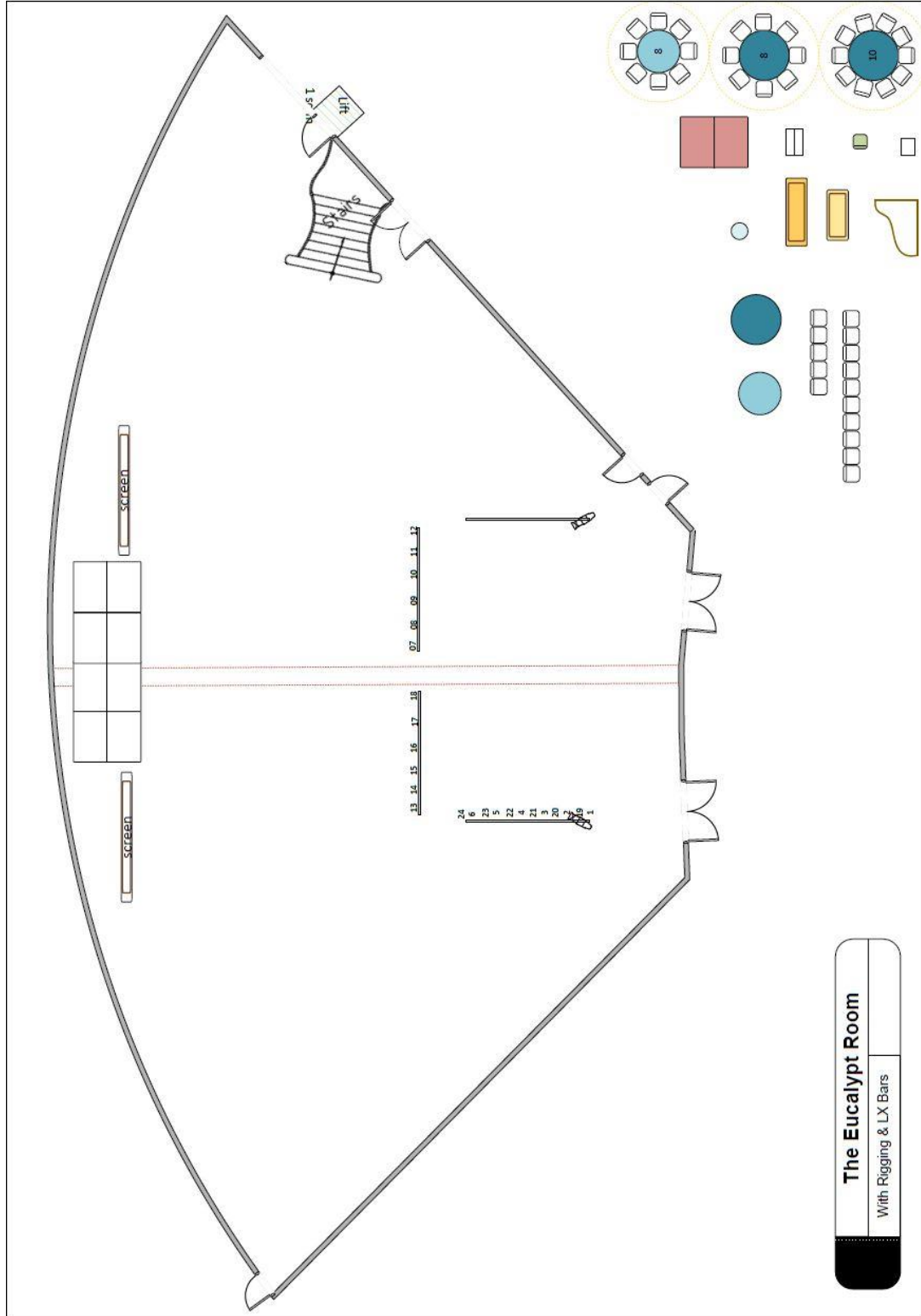

PRACC

PLENTY RANGES ARTS
& CONVENTION CENTRE